

**CMPZ4614
THRU
CMPZ4627**

**350mW LOW NOISE ZENER DIODE
5% TOLERANCE**

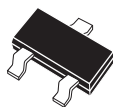

SOT-23 CASE

Central™

Semiconductor Corp.

DESCRIPTION:

The CENTRAL SEMICONDUCTOR CMPZ4614 Series types are high quality silicon zener diodes designed for low leakage, low current and low noise applications.

MARKING CODE: CONSULT FACTORY

MAXIMUM RATINGS: ($T_A=25^\circ\text{C}$ unless otherwise noted)

Power Dissipation
Operating and Storage Temperature

SYMBOL

P_D 350
 T_J, T_{stg} -65 to +150

UNITS

mW
 $^\circ\text{C}$

ELECTRICAL CHARACTERISTICS: ($T_A=25^\circ\text{C}$ unless otherwise noted) $V_F=1.0\text{V MAX @ } I_F=200\text{mA}$ FOR ALL TYPES.

TYPE NO.	ZENER VOLTAGE	TEST CURRENT	MAXIMUM ZENER IMPEDANCE	MAXIMUM REVERSE LEAKAGE CURRENT		MAXIMUM ZENER CURRENT	MAXIMUM NOISE DENSITY
	$V_Z @ I_{ZT}$	I_{ZT}	$Z_{ZT} @ I_{ZT}$	$I_R @ V_R$		I_{ZM}	$N_D @ I_{ZT}$
	VOLTS	μA	Ω	μA	VOLTS	mA	$\mu\text{V}/\sqrt{\text{Hz}}$
CMPZ4614*	1.8	250	1200	7.5	1.0	120	1.0
CMPZ4615*	2.0	250	1250	5.0	1.0	110	1.0
CMPZ4616*	2.2	250	1300	4.0	1.0	100	1.0
CMPZ4617*	2.4	250	1400	2.0	1.0	95	1.0
CMPZ4618*	2.7	250	1500	1.0	1.0	90	1.0
CMPZ4619*	3.0	250	1600	0.8	1.0	85	1.0
CMPZ4620*	3.3	250	1650	7.5	1.5	80	1.0
CMPZ4621*	3.6	250	1700	7.5	2.0	75	1.0
CMPZ4622*	3.9	250	1650	5.0	2.0	70	1.0
CMPZ4623*	4.3	250	1600	4.0	2.0	65	1.0
CMPZ4624*	4.7	250	1550	10	3.0	60	1.0
CMPZ4625*	5.1	250	1500	10	3.0	55	2.0
CMPZ4626*	5.6	250	1400	10	4.0	50	4.0
CMPZ4627*	6.2	250	1200	10	5.0	45	5.0

* Available on special order only, please consult factory.

SOT-23 CASE - MECHANICAL OUTLINE

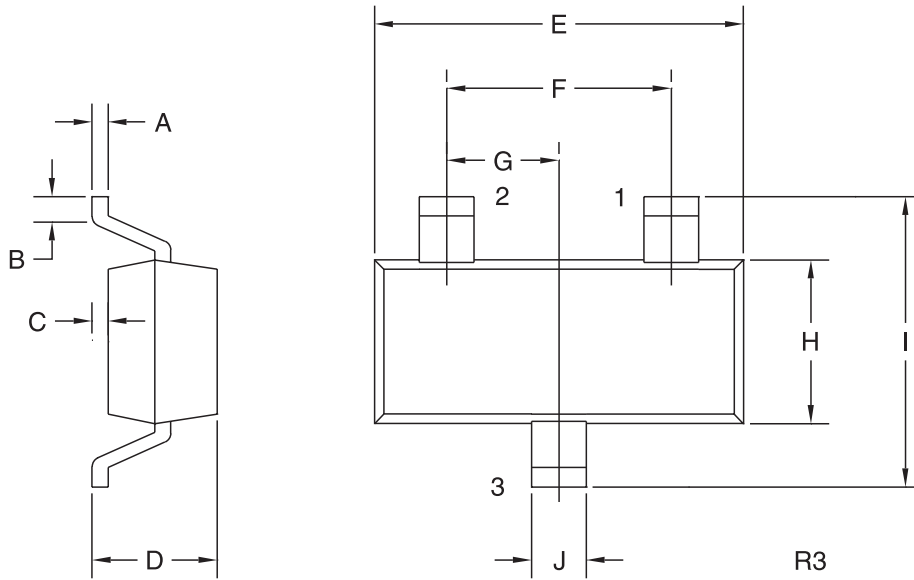

LEAD CODE:

- 1) ANODE
- 2) NO CONNECTION
- 3) CATHODE

**MARKING CODE:
CONSULT FACTORY**

SYMBOL	DIMENSIONS			
	INCHES		MILLIMETERS	
	MIN	MAX	MIN	MAX
A	0.003	0.007	0.08	0.18
B	0.006	-	0.15	-
C	-	0.005	-	0.13
D	0.035	0.043	0.89	1.09
E	0.110	0.120	2.80	3.05
F	0.075		1.90	
G	0.037		0.95	
H	0.047	0.055	1.19	1.40
I	0.083	0.098	2.10	2.49
J	0.014	0.020	0.35	0.50

SOT-23 (REV: R3)