

CMSD7000
SUPERmini™
DUAL SILICON SWITCHING DIODE
SERIES CONNECTION

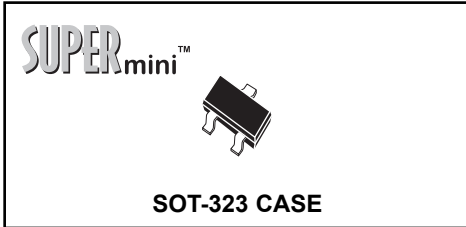

Central™

Semiconductor Corp.

DESCRIPTION:

The CENTRAL SEMICONDUCTOR CMSD7000 type is a ultra-high speed silicon switching diodes manufactured by the epitaxial planar process, in an epoxy molded super-mini surface mount package, connected in a series configuration, designed for high speed switching applications.

MARKING CODE: 5CC

MAXIMUM RATINGS: ($T_A = 25^\circ\text{C}$)

	SYMBOL		UNITS
Peak Repetitive Reverse Voltage	V_{RRM}	100	V
Average Forward Current	I_O	200	mA
Peak Forward Current	I_{FM}	500	mA
Power Dissipation	P_D	250	mW
Operating and Storage			
Junction Temperature	T_J, T_{stg}	-65 to +150	$^\circ\text{C}$
Thermal Resistance	θ_{JA}	500	$^\circ\text{C/W}$

ELECTRICAL CHARACTERISTICS PER DIODE: ($T_A = 25^\circ\text{C}$ unless otherwise noted)

SYMBOL	TEST CONDITIONS	MIN	TYP	MAX	UNITS
BV_R	$I_R = 100\mu\text{A}$	100			V
I_R	$V_R = 50\text{V}$			300	nA
I_R	$V_R = 50\text{V}, T_A = 125^\circ\text{C}$			100	μA
I_R	$V_R = 100\text{V}$			500	nA
V_F	$I_F = 1.0\text{mA}$	0.55		0.70	V
V_F	$I_F = 10\text{mA}$	0.67		0.82	V
V_F	$I_F = 100\text{mA}$	0.75		1.10	V
C_T	$V_R = 0, f = 1.0\text{ MHz}$			1.5	pF
t_{rr}	$I_R = I_F = 10\text{mA}, R_L = 100\Omega, \text{Rec. to } 1.0\text{mA}$		2.0	4.0	ns

SOT-323 CASE - MECHANICAL OUTLINE

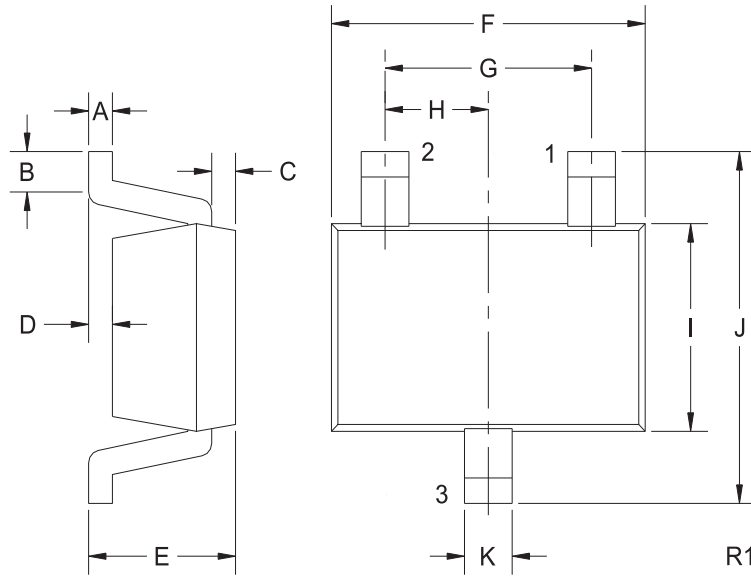

LEAD CODE:

- 1) ANODE 2
- 2) CATHODE 1
- 3) ANODE 1, CATHODE 2

MARKING CODE: 5CC

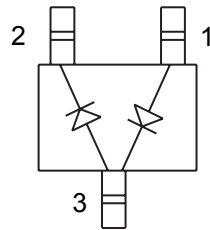

SYMBOL	DIMENSIONS			
	INCHES		MILLIMETERS	
	MIN	MAX	MIN	MAX
A	0.004	0.008	0.10	0.20
B	0.004	-	0.10	-
C	0.004	0.008	0.10	0.20
D	-	0.004	-	0.10
E	0.031	0.043	0.80	1.10
F	0.071	0.087	1.80	2.20
G	0.051		1.30	
H	0.026		0.65	
I	0.045	0.053	1.15	1.35
J	0.079	0.087	2.00	2.20
K	0.008	0.016	0.20	0.40

SOT-323 (REV: R1)